

AIRCRAFT PARKING/
DOCKING CHART - ICAO

APRON ELEV 6M

TWR: 118.35 PRI
118.05 SRY
GROUND: 121.6 PRI
121.9 SRY

DA NANG/DA NANG INTL (VVDN)

VAR 0°40'W
N
NOT TO SCALE

CHANGES: RENAME TWYS; ADDITION OF HOLDING POSITION OF TWY E; REMARKS, LEGEND.

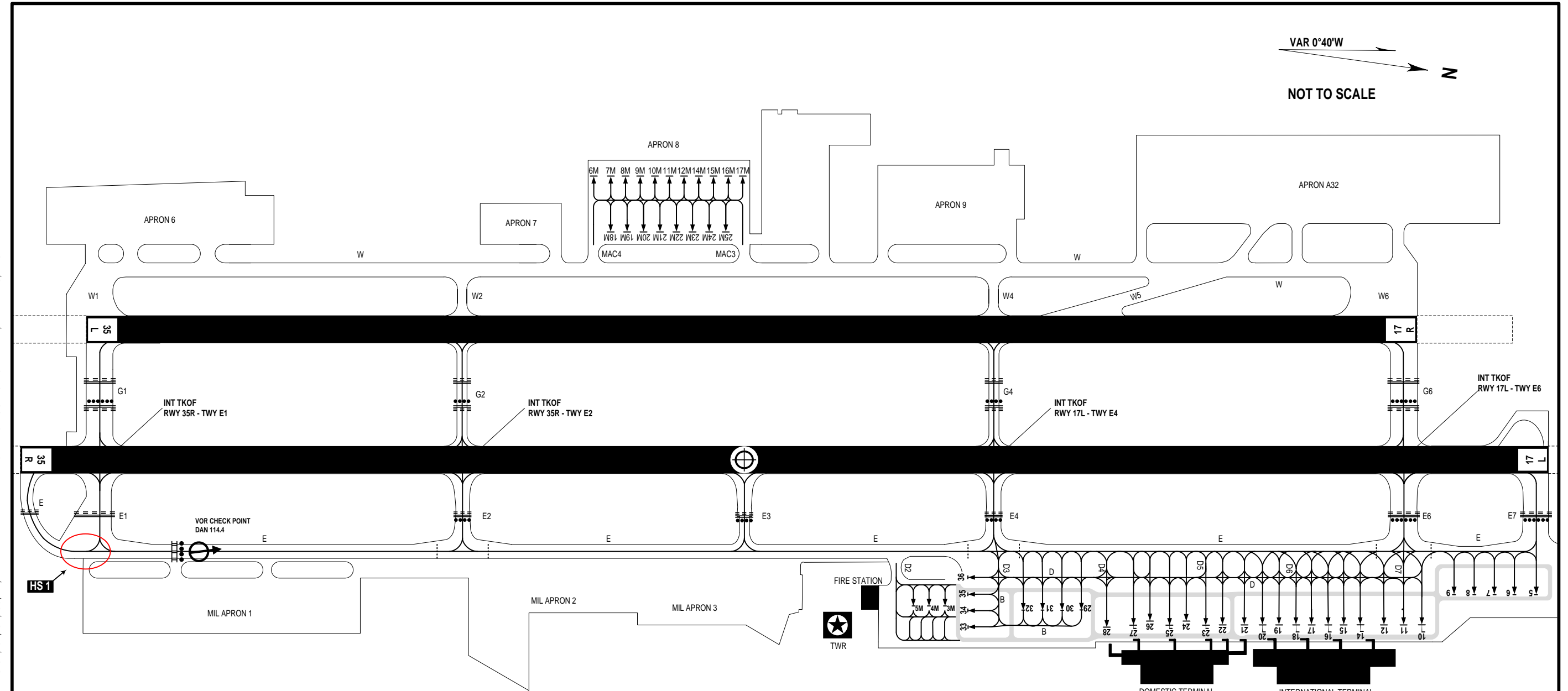

- REMARKS:**
- * OPERATIONAL PROCEDURE:
 - AIRCRAFT STANDS 5, 6, 7, 8, 9, 11, 12: USED FOR AIRCRAFT CODE C (WINGSPAN UP TO BUT NOT INCLUDING 36 M);
 - AIRCRAFT STANDS 10, 24, 26: + USED FOR AIRCRAFT CODE C (WINGSPAN UP TO BUT NOT INCLUDING 36 M);
+ USED FOR AIRCRAFT CODE E (WINGSPAN UP TO BUT NOT INCLUDING 65 M) WHEN THERE IS NO AIRCRAFT PARKING AT ADJACENT STANDS.
 - AIRCRAFT STAND 14: + USED FOR AIRCRAFT CODE C (WINGSPAN UP TO BUT NOT INCLUDING 36 M);
+ USED FOR AIRCRAFT CODE E (WINGSPAN UP TO BUT NOT INCLUDING 65 M) WHEN THERE IS NO AIRCRAFT PARKING AT STAND 15 AND STAND 12 IS USED FOR PARKING AIRCRAFT WITH WINGSPAN UP TO BUT NOT INCLUDING 28 M ONLY;
+ USED FOR AIRCRAFT CODE D (WINGSPAN UP TO BUT NOT INCLUDING 52 M) WHEN THERE IS NO AIRCRAFT PARKING AT STAND 15 AND STAND 12 IS USED FOR PARKING AIRCRAFT WITH WINGSPAN UP TO BUT NOT INCLUDING 36 M ONLY;
+ EQUIPPED WITH PASSENGER BRIDGE.
 - AIRCRAFT STANDS 15, 17, 19: ONLY USED FOR AIRCRAFT WITH WINGSPAN UP TO BUT NOT INCLUDING 28 M WHEN THERE IS NO AIRCRAFT WITH WINGSPAN MORE THAN 28 M PARKING AT ADJACENT STANDS.
 - AIRCRAFT STANDS 16, 18, 20, 23, 25: + USED FOR AIRCRAFT CODE C (WINGSPAN UP TO BUT NOT INCLUDING 36 M);
+ USED FOR AIRCRAFT CODE E (WINGSPAN UP TO BUT NOT INCLUDING 65 M) WHEN THERE IS NO AIRCRAFT PARKING AT ADJACENT STANDS;
+ EQUIPPED WITH PASSENGER BRIDGE.
 - AIRCRAFT STANDS 21, 22, 28: + USED FOR AIRCRAFT CODE C (WINGSPAN UP TO BUT NOT INCLUDING 36 M);
+ EQUIPPED WITH PASSENGER BRIDGE.
 - AIRCRAFT STAND 27: + USED FOR AIRCRAFT CODE C (WINGSPAN UP TO BUT NOT INCLUDING 36 M);
+ USED FOR AIRCRAFT CODE E (WINGSPAN UP TO BUT NOT INCLUDING 65 M) WHEN THERE IS NO AIRCRAFT PARKING AT STAND 26 AND STAND 28 STILL USED FOR AIRCRAFT CODE C (WINGSPAN UP TO BUT NOT INCLUDING 36 M);
+ EQUIPPED WITH PASSENGER BRIDGE.
 - AIRCRAFT STANDS 29, 30, 31, 32: + USED FOR AIRCRAFT UP TO CODE C AND EQUIVALENT (WINGSPAN UP TO BUT NOT INCLUDING 36 M);
+ STANDS 30, 31 USED FOR AIRCRAFT CODE D, E (WINGSPAN 36 M UP TO BUT NOT INCLUDING 65 M) WHEN THERE IS NO AIRCRAFT PARKING AT THE ADJACENT STANDS.
 - AIRCRAFT STANDS 33, 34, 35, 36: + USED FOR AIRCRAFT WITH WINGSPAN UP TO BUT NOT INCLUDING 30 M;
+ WHEN STANDS 33, 34, 35 USED FOR AIRCRAFT A321 OR EQUIVALENT, THE ADJACENT STANDS ONLY USED FOR AIRCRAFT WITH WINGSPAN UP TO BUT NOT INCLUDING 24 M.
 - AIRCRAFT STANDS 3M, 4M, 5M: + USED FOR AIRCRAFT WITH WINGSPAN UP TO BUT NOT INCLUDING 30 M;
+ IT IS NOT ALLOWED ANY AIRCRAFT TO TAXI BEHIND OF STANDS 3M, 4M, 5M WHEN THERE IS ANOTHER AIRCRAFT.

LEGEND	
VOR CHECK POINT	
HOT SPOT AND NUMBER	
NUMBER OF STAND POSITION	1
TAXI LANE	
INTERMEDIATE HOLDING POSITION	
TAXI - HOLDING POSITION PRECISION APCH RWY	
STOP BAR	
ARP	